

**TruExterior**<sup>®</sup>  
Siding & Trim

**BOARD-AND-BATTEN SIDING INSTALLATION INSTRUCTIONS**



## INTRODUCTION TO TRUEXTERIOR SIDING & TRIM

TruExterior Siding & Trim is made with an innovative poly-ash material that is highly resistant to moisture and termites, and offers a high level of dimensional stability. It cuts and installs with carbide woodworking tools and meets or exceeds most code requirements. For additional information, visit the resources page on [TruExterior.com](http://TruExterior.com).

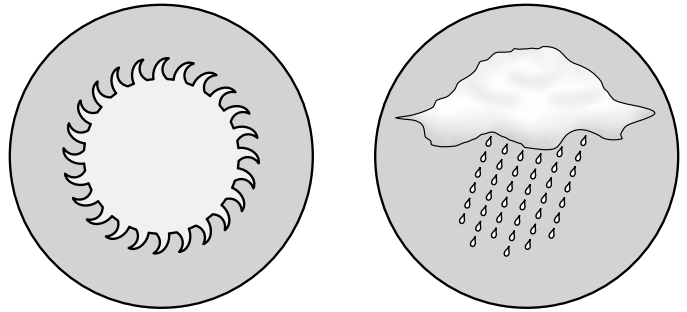

### MATERIALS & TOOLS

#### Materials

- TruExterior Boards: typically 11-1/4" wide
- TruExterior Batten: typically 2-1/2" wide
- Drainable weather-resistant barrier
- Flashing, flashing tape
- 6D or 8D stainless steel or hot-dipped ring shank nails
- High-grade, exterior caulk
- Exterior acrylic paint or solid color stain

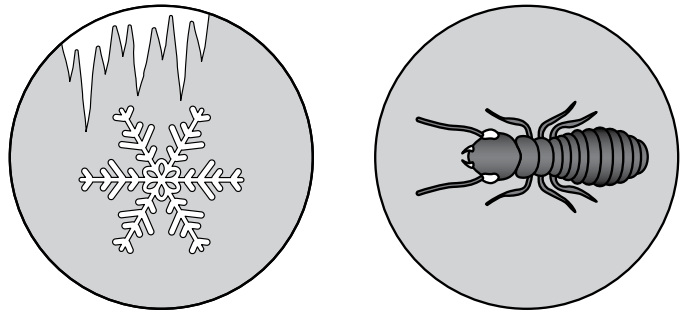

#### Tools

- Carbide woodworking tools
- Tape measure
- Chalk line
- Eye protection
- Respirator
- Gloves

### STORAGE AND HANDLING

- Product must be stored flat on a level surface in a clean, dry location (**Fig. 1**).
- Keep product wrapped and protected from the elements until ready for installation (**Fig. 1**).
- Installing product wet or saturated may result in gapping at joint locations.

### APPLICATIONS

TruExterior Siding and Trim offer exceptional durability in virtually any application. It's an ideal choice for both hot, freezing, windy and wet climates.

#### Approved for:

- Ground contact
- Contact with masonry or brick

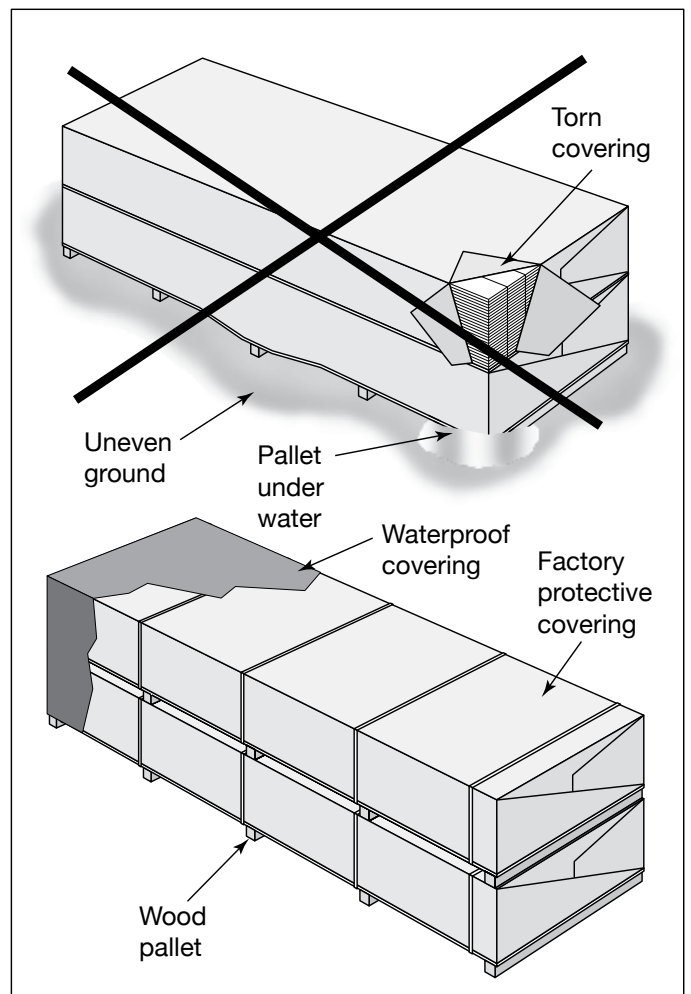

Fig. 1

## APPROVED WALL PREPARATION

### Traditional Wood Framed Walls

- TruExterior Board-and-Batten Siding must be installed on frame-built walls with studs spaced 16 in. O.C. or at most 24 in. O.C. (**Fig. 2**).
- Wall sheathing must meet local codes and have a minimum thickness of 7/16" for O.S.B. or 15/32" for plywood (**Fig. 2**)

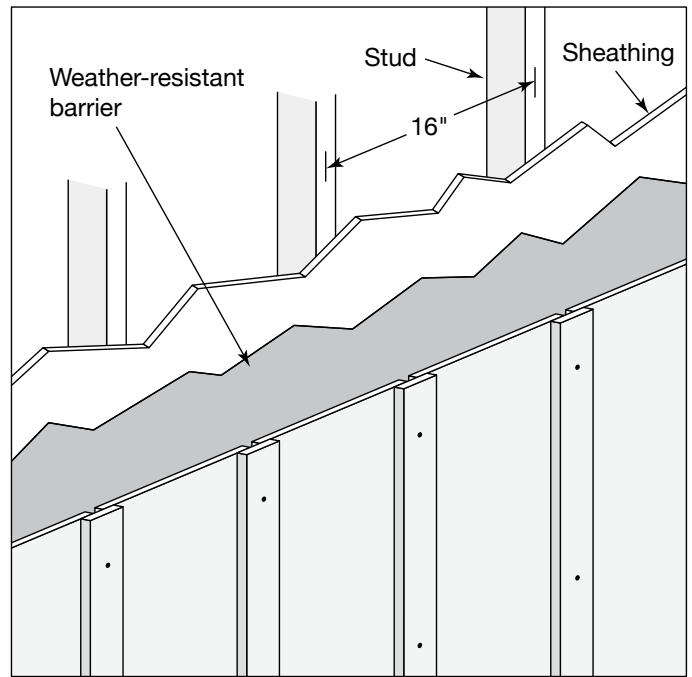

Fig. 2

## MANAGING MOISTURE

- Always install a drainable weather-resistant barrier according to local building code requirements (**Fig. 3**).
- Avoid installing products in standing water or areas that can stop water from draining away.

### Installing Flashing

- Prepare your step flashing along roof and wall lines using your weather barrier, flashing tape or z-flashing as counter flashing (**Fig. 3**).
- Allow 1/2" clearance between the siding and the roof line to help prevent debris from building up (**Fig. 3**).
- Install window and door flashing in the same manner when installing trim.
- Your boards may be installed right up against the trim and sealed with a high-grade, exterior acrylic caulk.

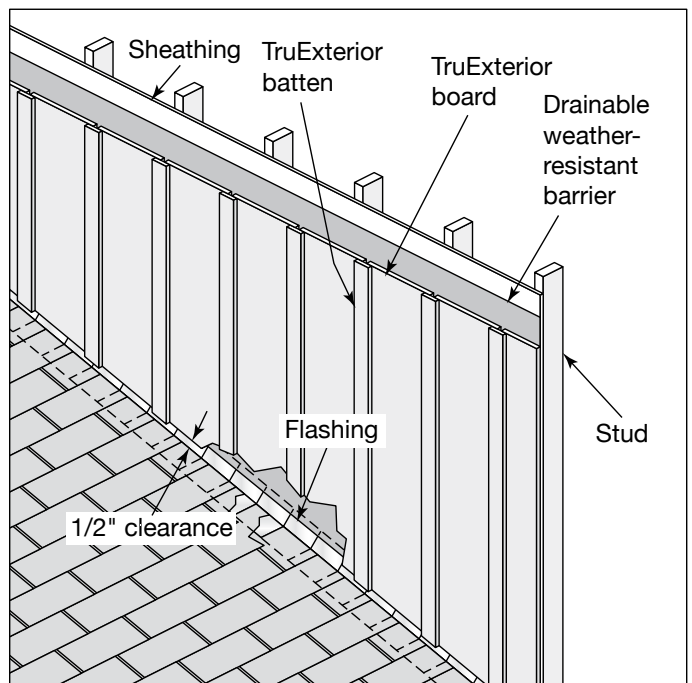

Fig. 3

## CUTTING TRUExTERIOR BOARD-AND-BATTEN

**Safety Note:** When cutting or shaping, avoid breathing dust. Use only outdoors or in a well-ventilated area. In case of inadequate ventilation, use respiratory protection. Always wear eye protection.

- There is no need to prime or paint end-cuts or field-cut edges
- TruExterior products can be cut, drilled and routed using carbide saw blades and woodworking tools to achieve custom shapes

## INSTALLING TRUExTERIOR BOARD-AND-BATTEN SIDING

### Nailing TruExterior Board-and-Batten Siding

- Use 6D or 8D stainless steel or hot-dipped ring shank nails to meet wind load requirements stated in the ES report PER – 13069. Check your local code requirements.
- Make sure your nail gun is set to drive the nail head even with the surface of the siding.
- If installing over sheets of foam insulation, make sure the length of your nail is adjusted to ensure it penetrates the sheathing or studs at least 1-1/4" deep

### Fastener Placement

- When installing boards, use 2 fasteners every 16" to 24", spaced no less than 3/4" from the edge (**Fig. 4**).
- When installing battens, use 1 fastener every 16" placed in the center (**Fig. 4**).

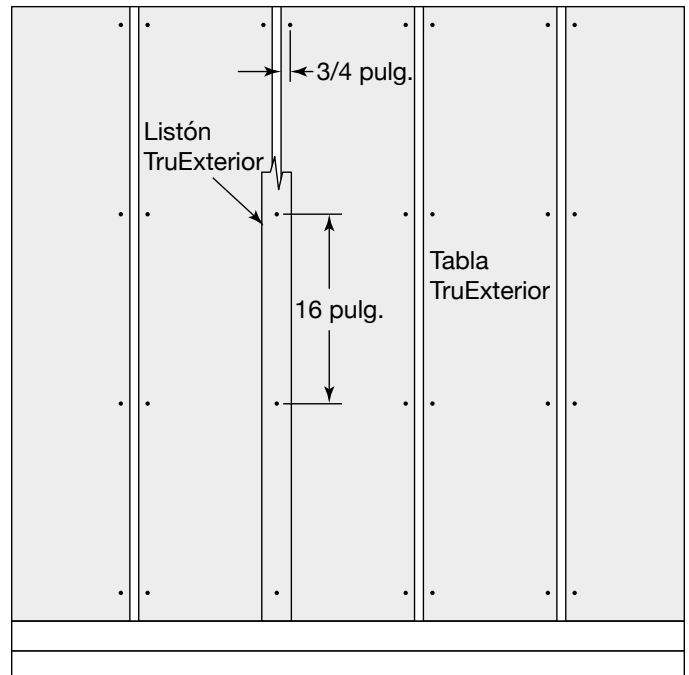

Fig. 4

## CHOOSING A LAYOUT

Decide if you want the center of your wall to be the center of a board or a batten.

### Center On Board

- Measure the width of the board and find the exact middle.
- Mark the center point of the board at the top and bottom (**Fig. 5a**).
- Using the plumb line on the wall, line up the middle of the board with the middle of the wall and secure it with fasteners (**Fig. 5a**).
- Use a 3/4" wide spacer between boards as you continue across the wall, checking for plumb along the way (**Fig. 5a**).
- There should be a max 9-1/2" reveal between each batten.

### Center On Batten

- Install the edge of the first board 3/8" from the plumb line center of the wall.
- Once the first board is installed, space boards 3/4" (**Fig. 5a**).

### Batten Installation

- Measure the board and chalk a line 7/8" from either edge to indicate the position of the battens (**Fig. 5a**).
- Install the first board so that it is 7/8" off the center line in either direction right or left.
- Use a 3/4" wide spacer between boards as you continue across the wall, checking for plumb along the way (**Fig. 5a**).
- There should be a max 9-1/2" reveal between each batten.

### Sealing Battens

There are two options for sealing battens.

- You can apply a bead of high-grade exterior acrylic caulk to both inside corners of the batten (**Fig. 5b**).
- You can alternatively apply a bead of high-grade exterior acrylic caulk to each board just prior to fastening the batten (**Fig. 5b**).

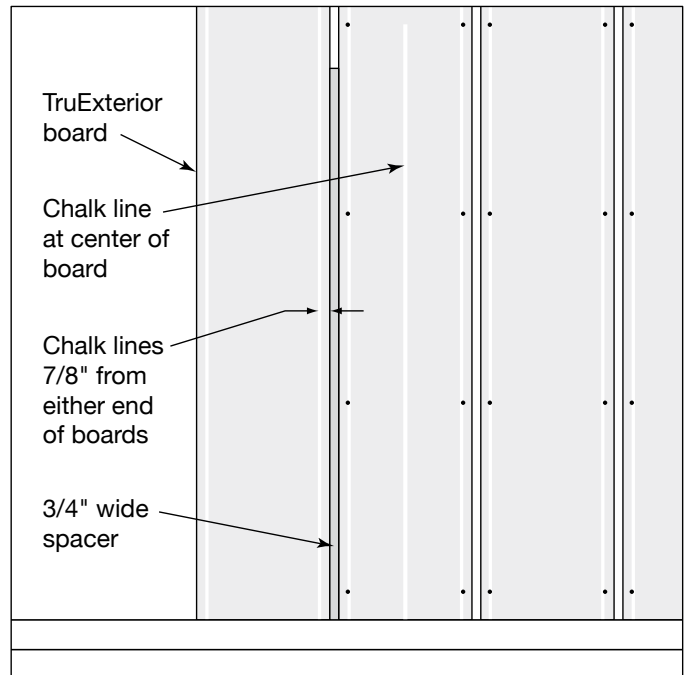

Fig. 5a

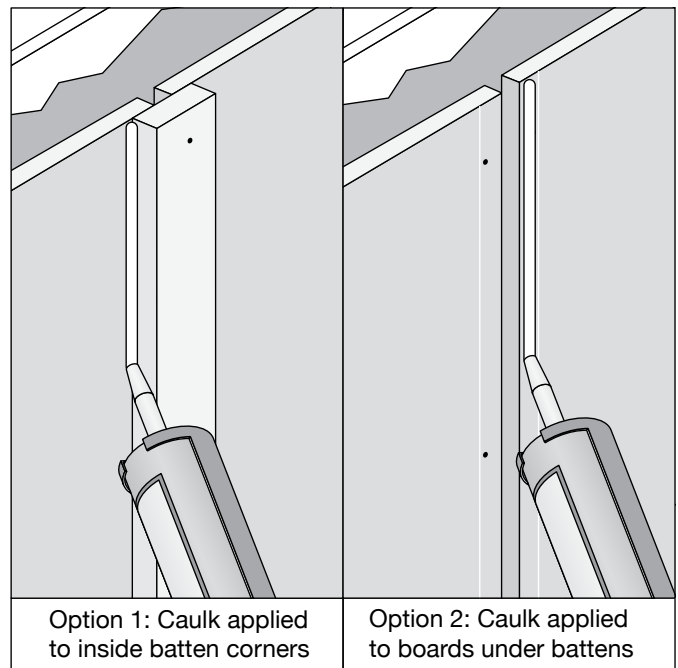

Fig. 5b

## INSTALLING TRUEXTERIOR TRIM

- When installing TruExterior Trim, choose a thickness that is equal or greater than the thickness of the battens to avoid resting water on the tops of the battens (**Fig. 6**).

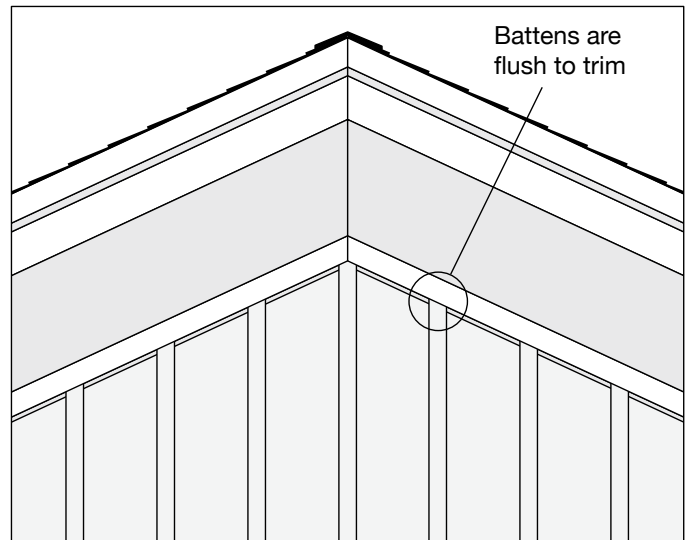

Fig. 6

## SEAMING TALL WALLS

There are two methods of seaming board-and-batten siding on tall walls. Both are effective in mitigating water away from the home.

### Belly Band Trim

- Use a piece of z flashing tucked under the drainable weather-resistant barrier that extends to the front face of your horizontal trim (**Fig. 7a**).
- This method allows you to give a home a stylish trim accent and extra detail.

### Flashed Butt Joint

- Use a piece of Z flashing tucked under the drainable weather-resistant barrier that extends to the front of your battens (**Fig. 7b**).
- This method allows a more seamless look but will be slightly visible when viewed closely.

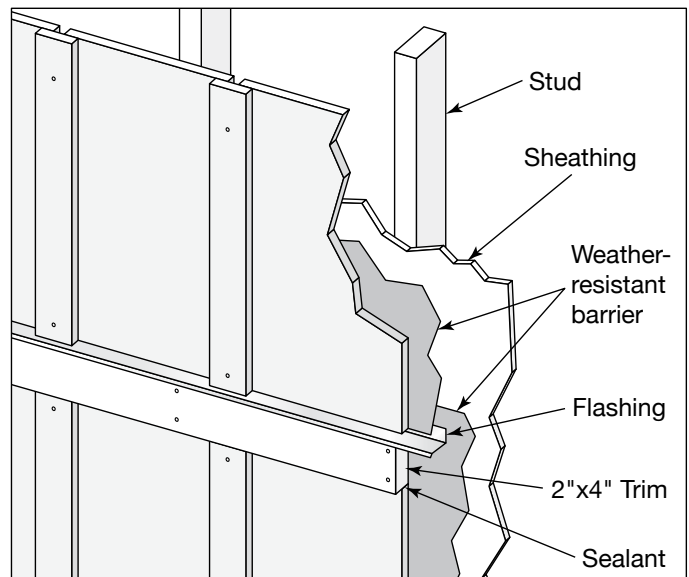

Fig. 7a

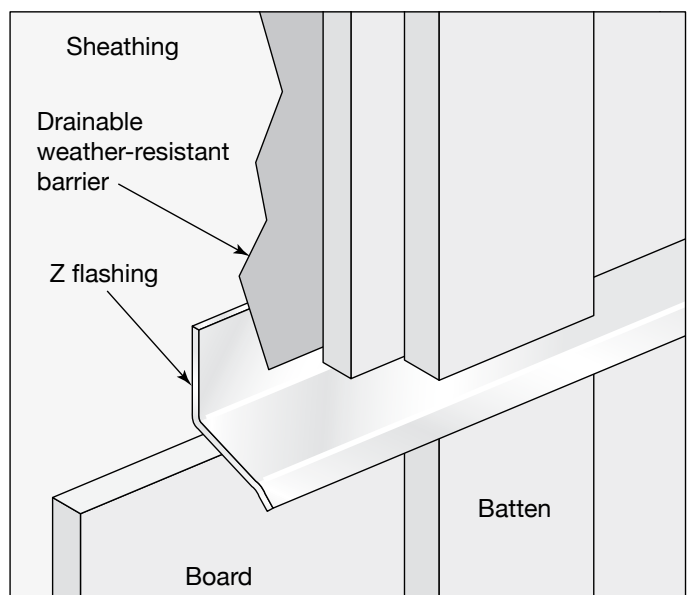

Fig. 7b



## INSTALLING INSIDE CORNERS

- When creating inside corners, install 2"x2" trim into the corner with an approved fastener (**Fig. 8**).
- Use 1 nail every 16" along the length on alternating sides of the trim, ensuring penetration into the framing.
- Butt the board up to the corner trim and secure in place (**Fig. 8**).
- Seal the joint between the corner trim and the siding with high-grade, exterior acrylic caulk (**Fig. 8**).

## INSTALLING OUTSIDE CORNERS

- Typical outside corners are created using 1"x5" and 1"x6" trim, installed using approved fasteners (**Fig. 9**).
- Secure each trim piece on top of the boards with 2 nails every 16" along the length of each piece of trim (**Fig. 9**).
- Stagger the nail pattern to prevent opposing nails from contacting each other
- Ensure that the nails penetrate the framing and the nails of the longer trim piece penetrate the shorter trim piece at the corner.
- Seal the joint between the outside corner trim and the siding with high-grade, exterior acrylic caulk (**Fig. 9**).

## SEALING GAPS

While TruExterior Siding & Trim products do not require priming or sealing of end cuts, a variety of caulks and sealants may be used in conjunction with the product to help prevent water intrusion to the structure.

## PAINT OR STAIN TRUExTERIOR PRODUCTS

**TruExterior siding requires paint or stain within 150 days of installation or the warranty will be void.**

- TruExterior products are dimensionally stable which promotes long-lasting paint and stain adhesion, even with dark colors.
- Nail holes, screw holes and minor dents and dings may be repaired with a high-grade exterior caulk or exterior wood filler.
- Use a high-grade exterior acrylic paint or solid color stain and follow the manufacturer's application instructions.
- Ensure all surfaces are free of dirt or other contaminants and completely dry before painting.
- Ensure that all exposed TruExterior Siding and Trim surfaces are adequately covered with paint or stain per the manufacturer's guidelines.
- When using a sprayer to apply paint or stain, it is best to back roll or back brush to avoid runs, drips or bubbles on the siding surface.

**Note:** For additional painting and staining information, please visit the resources page on [TruExterior.com](http://TruExterior.com).

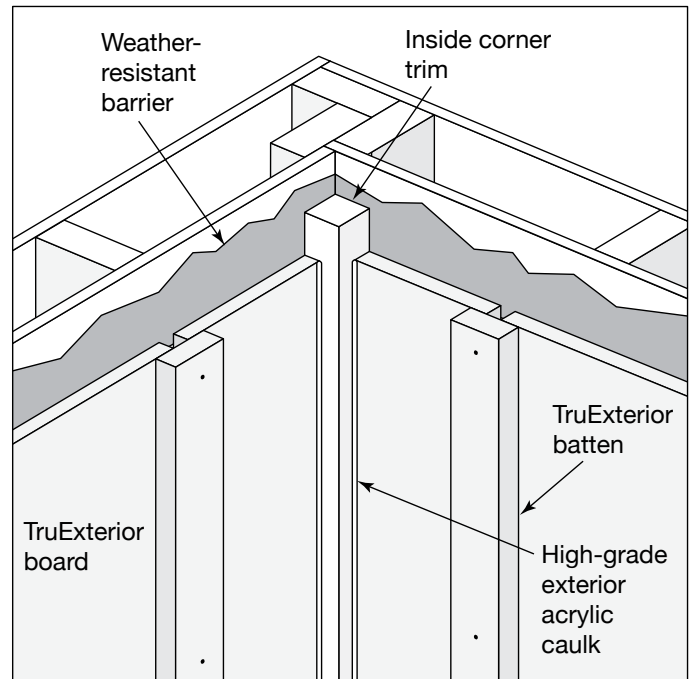

Fig. 8

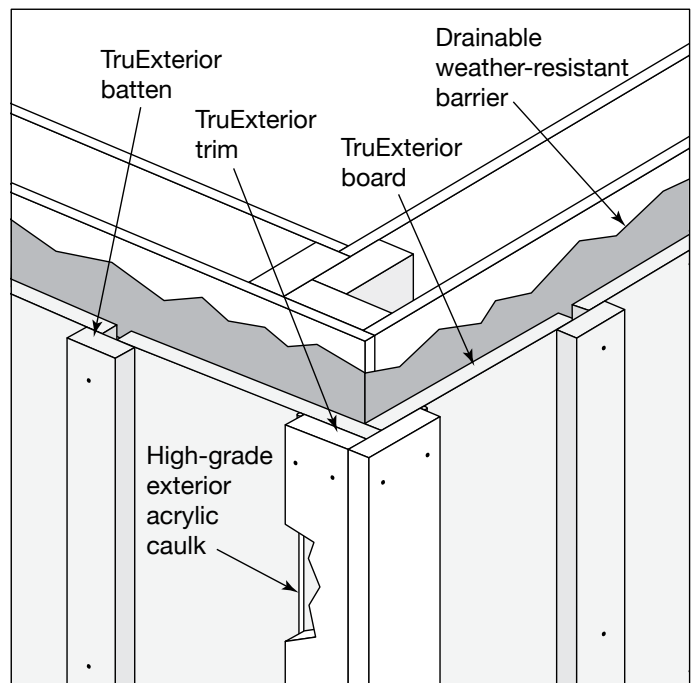

Fig. 9



## Board-and-Batten Siding Installation Instructions

TruExterior.com | 800-521-8486

**Made in the USA**